

To Replace Clicker Blade:

Hold black bellows in one hand; lift up and turn grey age selector counterclockwise until unit disassembles. In some cases, a flat head screwdriver may be required to pry off the age selector. (Fig. 1) Remove screw and install new clicker blade with existing screw. (Fig. 2 & 3)

To Reassemble:

Line up tabs on age selector with slots on bellows (will only go on one way). Hold black bellows in one hand; push down and turn grey age selector clockwise to lock into place.

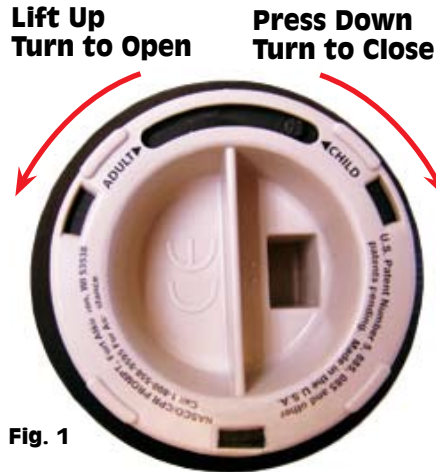

Remove Screw **Broken Clicker**

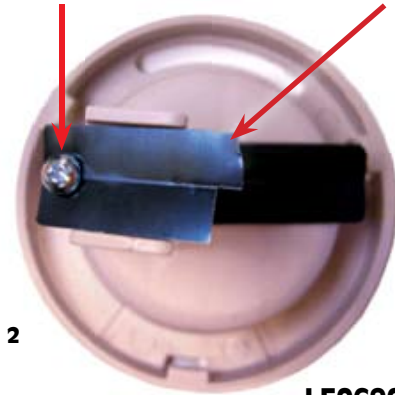

Fig. 2

**Screw Back
in Place**

**LF06909U
Replacement
Clicker (Pk 5)**



Fig. 3

CAUTION: CLICKER BLADES MAY HAVE SHARP EDGES.